

ASSEMBLY INSTRUCTIONS

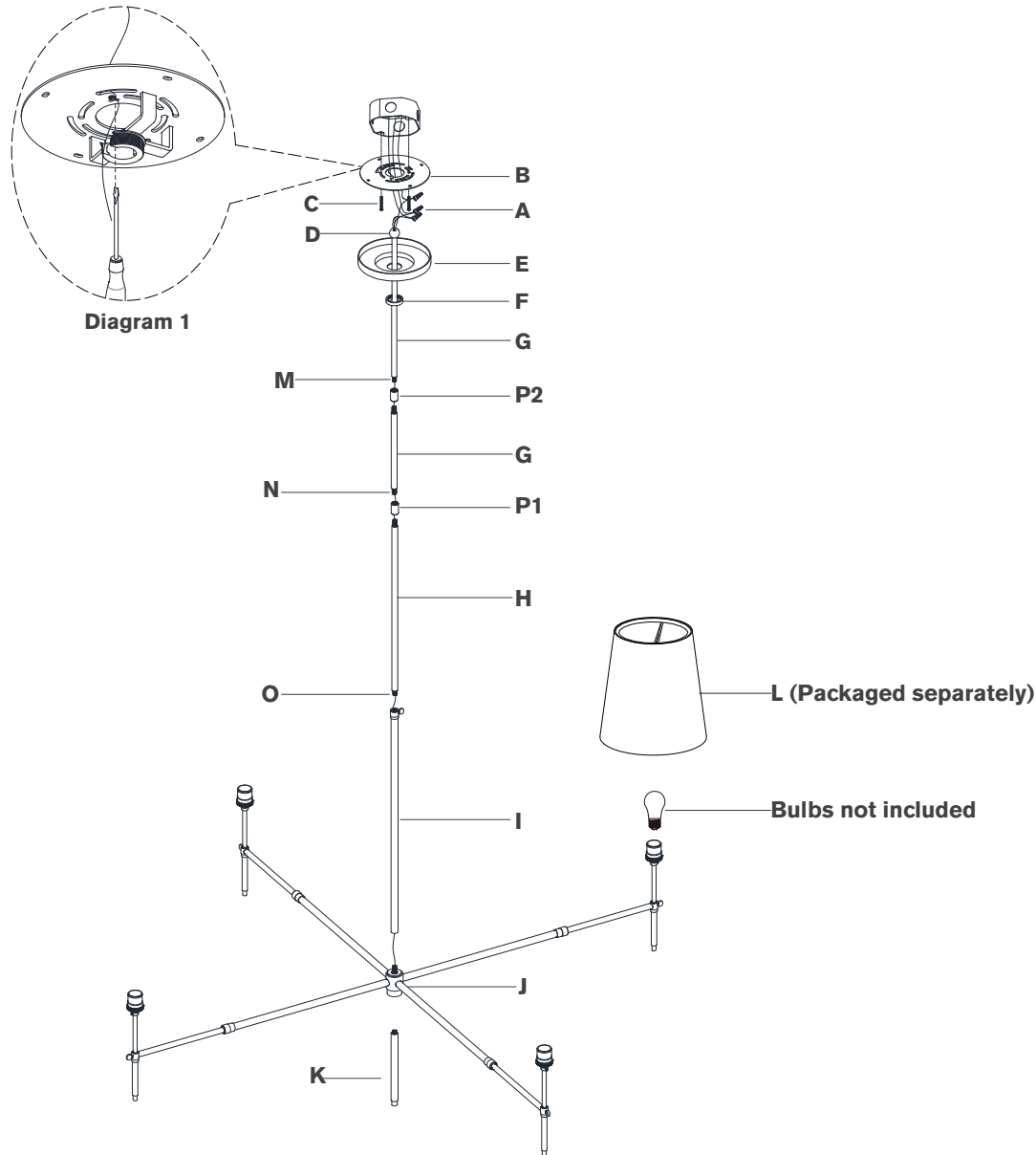

Bryant Grande Chandelier

Item # TOB 5196

NOTICE:

This light fixture should be installed in accordance with all applicable, local installation codes, and by a person familiar with the construction and operation of it, as well as the hazards involved. Inspect item and contents carefully. If any damage or defect is found, do not install. Retain all packaging material until installation is complete and approved.

TOOLS REQUIRED (NOT INCLUDED):

Phillips Screwdriver	Slotted Screwdriver	Wire Cutters
Slip Joint Pliers	Wire Strippers	

1. Carefully remove all parts from the box. Place on a clean, soft surface.
2. Remove mounting plate (B) from canopy (E) by removing collar ring (F).
3. Install mounting plate (B) to junction box and secure with mounting screws (C).
4. Thread rod (I) to fixture body (J).
5. Feed fixture wires through threaded rod (O) and rod (H), then connect to rod (I) and secure with coupling (P1). Repeat for threaded rod (N) and rod (G), connecting to coupling (P1) and secure with coupling (P2).
6. Continue feeding fixture wires through threaded rod (M), rod (F), collar ring (F) and canopy (E).
7. Holding fixture upright, slide collar ring (F), canopy (E) down rods and rest on top of rod (I). Then connect threaded rod (M) and rod (G) to coupling (P2).

NOTE: Slide components down slowly to avoid damages.

8. Hang fixture swivel ball (D) to center of mounting plate (B).
9. Cut excess wires, being sure to leave enough to reach the junction box. Separate wires, and strip insulation on each 5/8".
10. Wrap fixture ground wire (bare copper) around the green grounding screw (see diagram 1). Tighten. Continue fixture ground wire and connect to supply ground wire (usually green or bare copper) using wire nut (A).

NOTE: It is imperative that the fixture is grounded.

ASSEMBLY INSTRUCTIONS

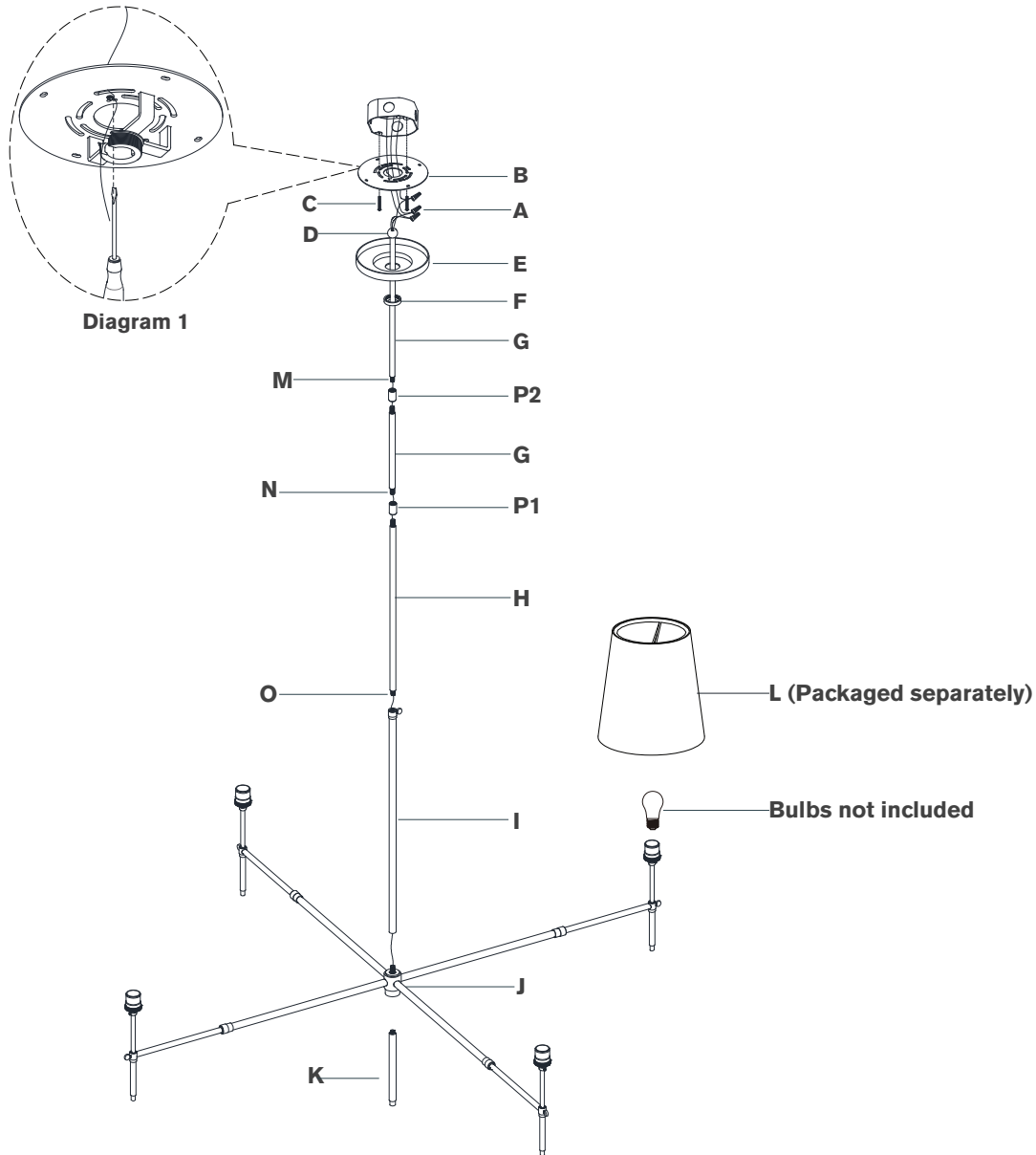

Bryant Grande Chandelier

Item # TOB 5196

NOTICE:

This light fixture should be installed in accordance with all applicable, local installation codes, and by a person familiar with the construction and operation of it, as well as the hazards involved. Inspect item and contents carefully. If any damage or defect is found, do not install. Retain all packaging material until installation is complete and approved.

11. Connect fixture neutral wire (white) to the supply neutral wire (usually white) using wire nut **(A)**.
12. Connect fixture hot wire (black) to the supply hot wire (usually black) using wire nut **(A)**.
13. Make sure all wire connections are tight, then carefully tuck into the junction box.
14. Install canopy **(E)** to mounting plate **(B)** and secure with collar ring **(F)**.
15. Thread finial **(K)** to the bottom of fixture body **(J)**.
16. Install light bulbs into sockets.
17. Clip shades **(L)** onto light bulbs.

NOTE: If shade has additional packaging, carefully cut off from interior of shade to avoid damages.

Care Instructions: Clean only with a soft dry cloth or feather duster. Do not use abrasive or chemical agents.